

Dimensions in mm

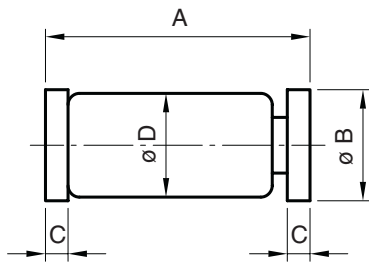

Mounting Pad Layout

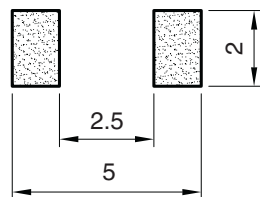

REF.	DIMENSIONS		
	Milimeters		
	Min.	Typ.	Max.
A	3.30	3.50	3.70
B	1.40	1.50	1.60
C	0.35	0.45	0.55
D	1.35	1.40	1.40

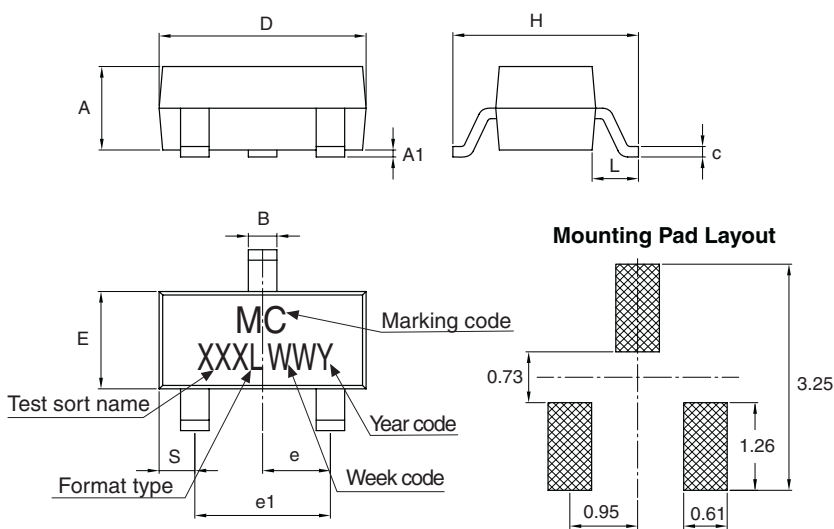

REF.	DIMENSIONS	
	Milimeters	
	Min.	Max.
A	0.89	1.4
A1	0.05	0.15
B	0.3	0.51
c	0.080	0.18
D	2.75	3.04
e	0.85	1.05
e1	1.7	2.1
E	1.2	1.6
H	2.1	2.75
L	0.40	0.70
S	0.45	0.65

Dimensions in mm

Package Outline



TO-261AA (SOT-223)

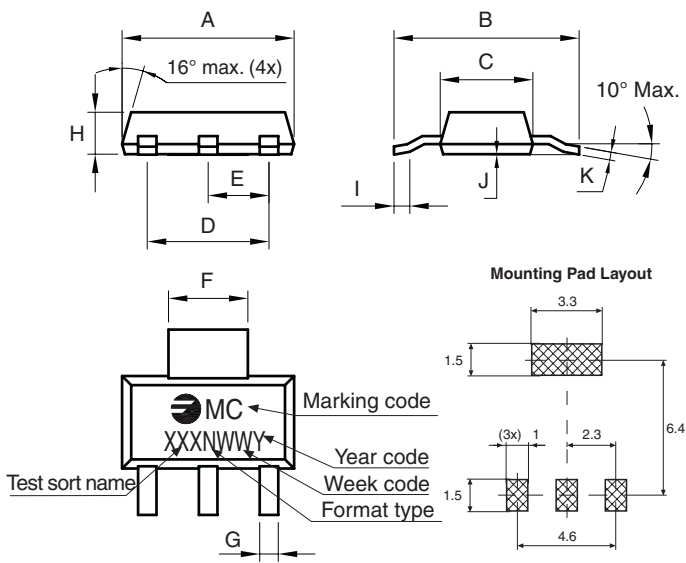

REF.	DIMENSIONS		
	Milimeters		
	Min.	Nominal	Max.
A	6.30	6.50	6.70
B	6.70	7.00	7.30
C	3.30	3.50	3.70
D	-	4.60	-
E	-	2.30	-
F	2.95	3.00	3.15
G	0.65	0.70	0.85
H	1.50	1.60	1.70
I	0.50	0.60	0.70
J	-	0.02	0.05
K	0.25	0.30	0.35

Dimensions in mm

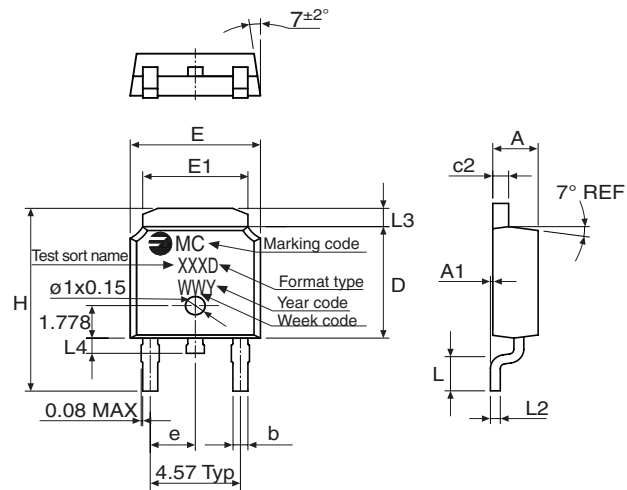

Mounting Pad Layout

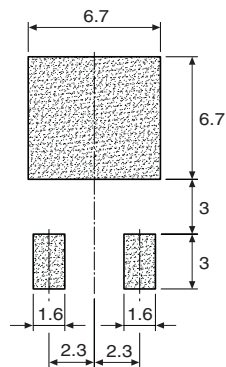

REF.	DIMENSIONS		
	Millimeters		
	Min.	Nominal	Max.
A	2.18	2.3	2.39
A1	0	0.127	0.127
b	0.64	0.75	0.89
c2	0.46	0.51	0.56
D	5.97	6.1	6.22
E	6.47	6.6	6.73
E1	5.20	5.34	5.46
e	2.28BSC		
H	9.77	10.03	10.28
L	1.31	1.44	1.57
L2	0.46	0.51	0.56
L3	0.89	1.02	1.14
L4	0.51	0.76	1.02

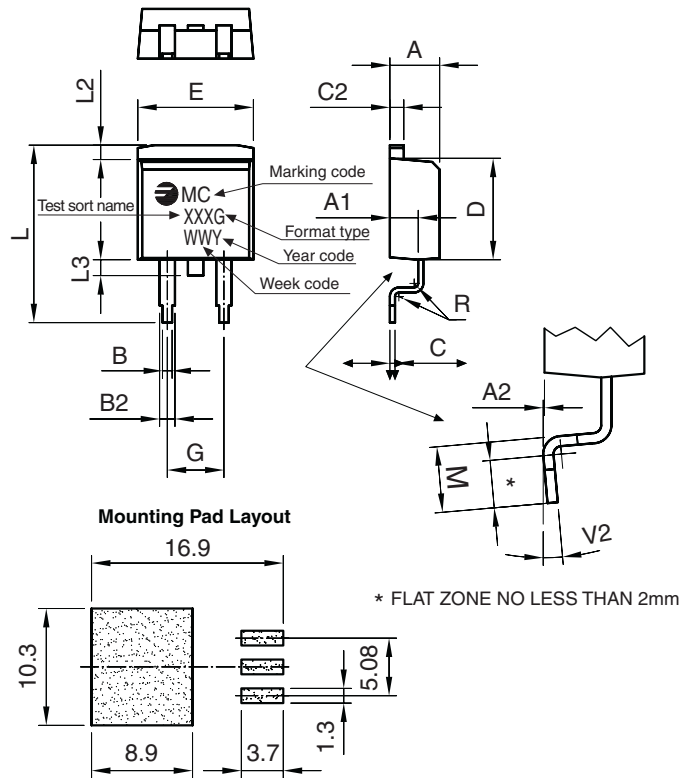
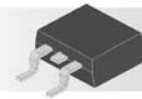

REF.	DIMENSIONS		
	Milimeters		
	Min.	Nominal	Max.
A	4.40	4.45	4.60
A1	2.49	2.50	2.69
A2	0.03	0.10	0.23
B	0.70	0.90	0.93
B2	1.14	1.03	1.70
C	0.45	0.45	0.60
C2	1.23	1.23	1.36
D	8.95	9.00	9.35
E	10.00	10.25	10.40
G	4.88	5.15	5.28
L	15.00	15.40	15.85
L2	1.27	1.27	1.40
L3	1.40	1.55	1.75
M	2.40	3.00	3.20
R		0.40 typ	
V2	0°		8°

Package Outline

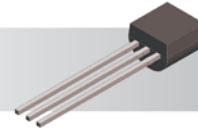

TO-92

TO-92

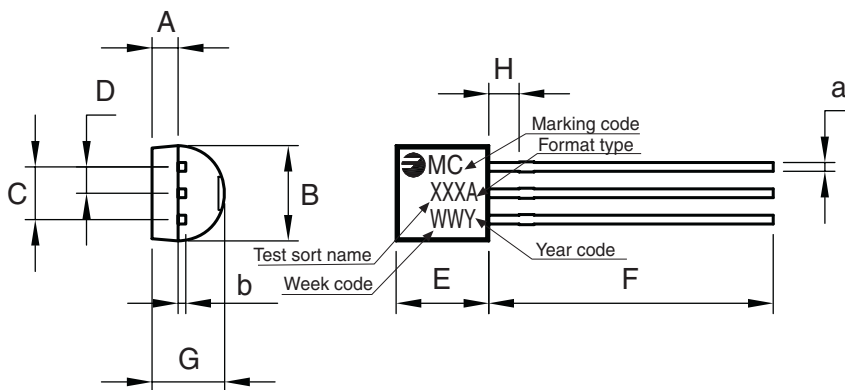

REF.	DIMENSIONS		
	Milimeters		
	Min.	Typ.	Max.
A	0.90	1.20	1.50
B	4.40	4.60	4.80
C	2.34	2.54	2.74
D	1.07	1.27	1.47
E	4.40	4.60	4.80
F	12.70	14.10	15.50
G	3.40	3.60	3.86
H	1.30	1.50	1.70
a	0.38	0.44	0.51
b	0.33	0.41	0.51

TO-92 (AMMO)

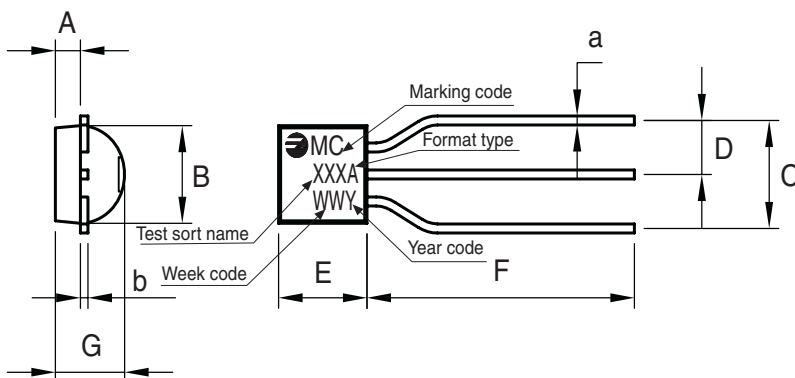

REF.	DIMENSIONS		
	Milimeters		
	Min.	Typ.	Max.
A	0.90	1.20	1.50
B	4.40	4.60	4.80
C	4.96	5.08	5.20
D	2.42	2.54	2.66
E	4.40	4.60	4.80
F	12.70	14.10	15.50
G	3.40	3.60	3.86
H	1.30	1.50	1.70
a	0.38	0.44	0.51
b	0.33	0.41	0.51

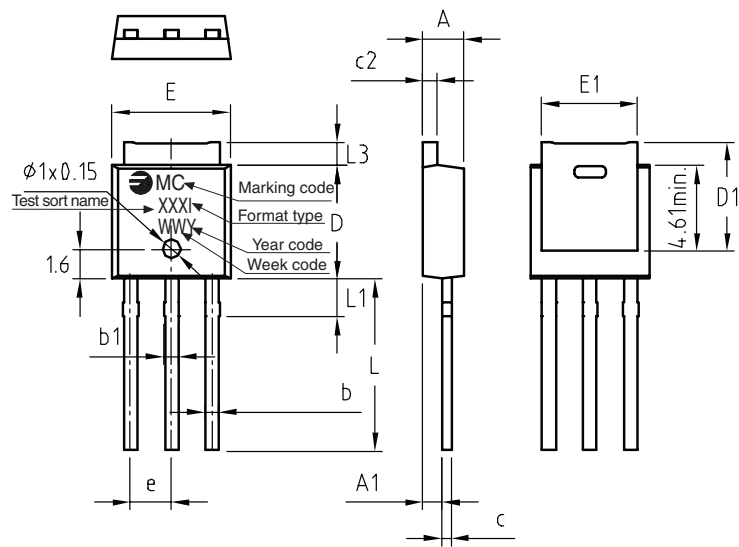

REF.	DIMENSIONS		
	Milimeters		
	Min.	Nominal	Max.
A	2.19	2.30 ± 0.11	2.41
A1	0.89	1.08 ± 0.19	1.27
b	0.50	0.70 ± 0.20	0.90
b1	0.70	0.92 ± 0.22	1.14
c	0.43	0.51 ± 0.08	0.59
c2	0.43	0.62 ± 0.19	0.81
D	5.40	5.81 ± 0.41	6.22
D1	5.70	5.90 ± 0.20	6.10
E	6.35	6.54 ± 0.19	6.73
E1	5.20	5.33 ± 0.13	5.46
e	2.25	2.30 ± 0.05	2.35
L	7.50	8.58 ± 1.08	9.66
L1	1.90	2.10 ± 0.20	2.28
L3	0.89	1.27 ± 0.38	1.65

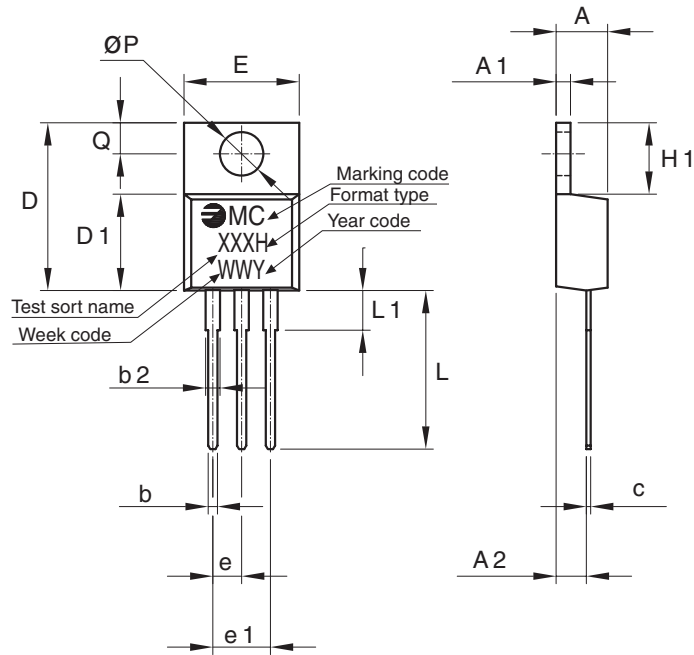
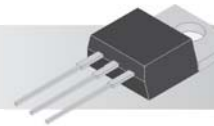

REF.	DIMENSIONS	
	Milimeters	
	Min.	Max.
A	4.47	4.67
A1	1.17	1.37
A2	2.52	2.82
b	0.71	0.91
b2	1.17	1.37
c	0.31	0.53
D	14.65	15.35
D1	8.50	8.90
E	10.01	10.36
e	2.51	2.57
e1	4.98	5.18
H1	6.15	6.45
L	13.40	13.96
L1	3.56	3.96
P	3.735	3.935
Q	2.59	2.89

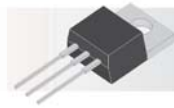

Optional with chamfer

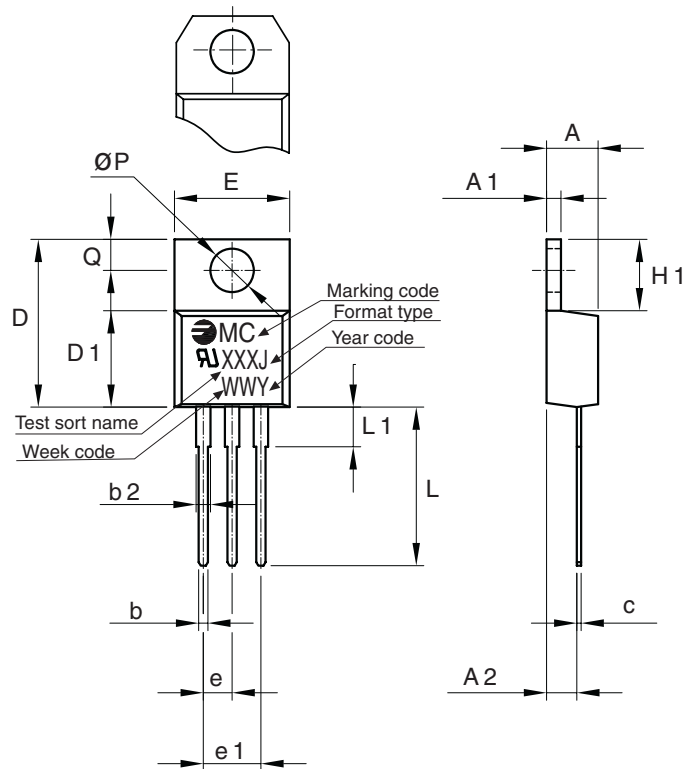

REF.	DIMENSIONS	
	Millimeters	
	Min.	Max.
A	4.32	4.62
A1	1.21	1.29
A2	2.40	2.70
b	0.80	0.83
b2	1.40	--
c	0.42	0.48
D	15.5	15.68
D1	9.26	9.42
E	10.08	10.24
e	2.54	2.54
e1	5.08	5.08
H1	6.24	6.26
L	12.81	13.81
L1	3.28	4.17
P	3.70	3.80
Q	2.75	2.85

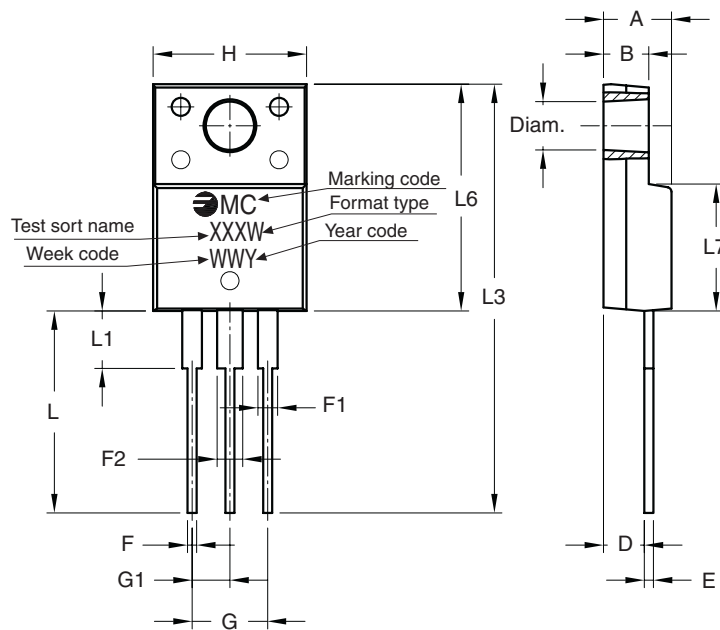

REF.	DIMENSIONS		
	Milimeters		
	Min.	Nominal	Max.
A	3.55	4.50	4.90
B	2.34	3.00	3.70
D	2.03	2.70	2.96
E	0.35	0.60	0.70
F	0.25	0.60	1.01
F1	0.70	1.30	1.78
F2	0.70	1.70	1.78
G	4.88	5.00	5.28
G1	2.34	2.50	2.74
H	9.65	10.15	10.67
L	12.70	13.35	14.73
L1	2.93	3.75	6.35
L3	26.90	28.35	31.20
L6	14.22	15.00	16.50
L7	8.30	8.40	9.59
Diam.	3.00	3.20	3.28

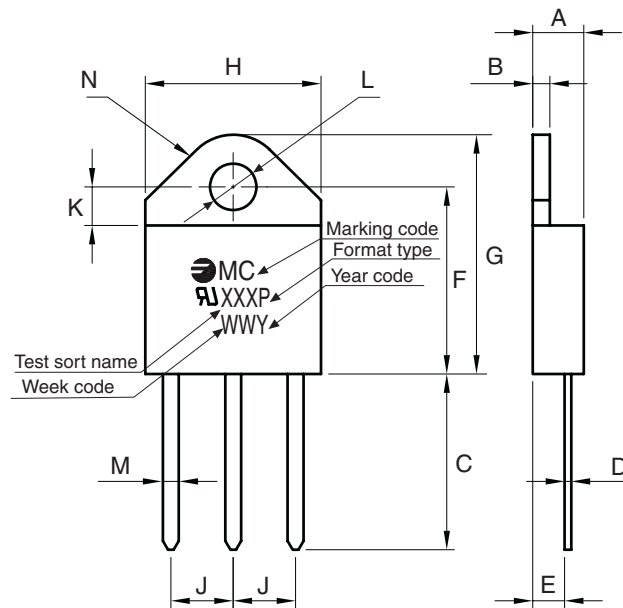
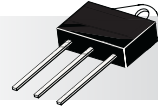

DIMENSIONS (mm)

	A	B	C	D	E	F	G	H	J	K	L	M	N
MAX	4.6	1.55	15.6	0.7	2.9	16.5	21.1	15.5	5.65	3.65	4.17	1.40	
TYP													4.60
MIN	4.4	1.45	14.35	0.5	2.7	15.8	20.4	15.1	5.4	3.4	4.08	1.20	

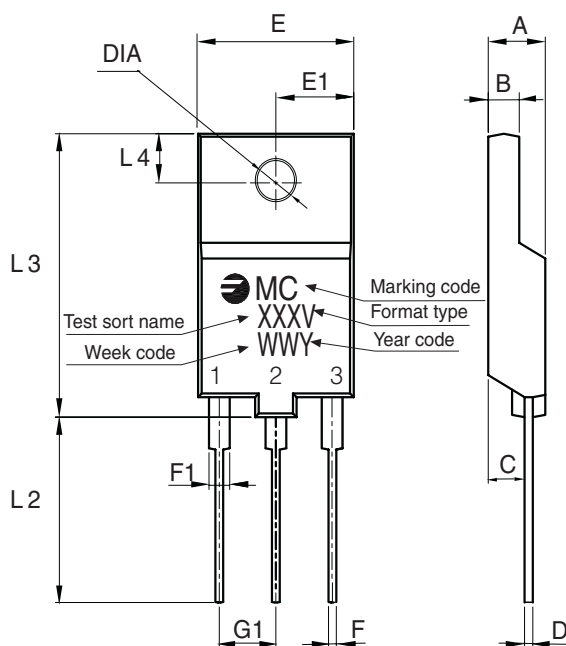
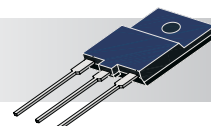

REF.	DIMENSIONS	
	Milimeters	
	Min.	Max.
A	4.90	5.5
B	2.5	3.0
C	3.3	3.6
D	0.6	0.9
E	15.0	15.5
E1	7.5	7.75
F	0.65	0.75
F1	1.7	2.0
G1	5.2	5.7
L2	16.5	17.0
L3	2.6	26.5
L4	4.25	4.75
DIA	3.35	3.85