



# Connectivity and networking

Offer your users easy and secure connectivity that works as they expect and demand.

**WIFI - WICONNECT**

**GPON**

**IP- ETHERNET**



**WIFI SERVICE**  
**WiConnect**



**HIGH CONNECTIVITY AND SECURE COVERAGE**

Fagor presents a set of solutions designed to achieve efficient, secure and responsible Internet access in a high capacity multiservice network infrastructure, using coaxial cable, Ethernet cable and fibre optics.

Through the device, the guest accesses the wifi network via the WICONNECT connection, without contacting the reception desk.

Professional management of guest wifi access, including:

Customisable captive portal, disclaimer with terms of service use.

Definition of different profiles and allocations of bandwidth, user/password, RRSS, email...



REF.	MOD.	DESCRIPTION
<b>SOFTWARE</b>		
10210	CSU 001	Cloud Connect Server
10350	FMO-050	WiConnect (hotspot)
<b>HARDWARE</b>		
10511	ROR 301 -UI	ROUTER



## CONNECTIVITY

# GPON TECHNOLOGY

GPON (Gigabit Passive Optical Network) is a telecommunications access technology that uses fibre optic cabling to reach the end user.

### What is Gpon?

- This access technology uses an OLT (Optical Line Termination) from which the optical fibres are routed to the ONTs (Optical Network Termination), end-user equipment that converts the optical signals coming through the fibre into electrical signals. The OLT is the element in charge of traffic propagation, bandwidth allocation... among other functions and the ONT is the equipment in charge of delivering the services to the end user.
- Thanks to this access technology we can reach the end user FTTx (Fiber To The x). Depending on who the end user is, there will be a different topology: FTTR (Fiber To The Room), FTTO (Fiber To The Office)...

### What does it allow you to do?

1. It allows you to carry multiple IP services over the fibre; VoIP, IPTV, internet...
2. High data transmission capacity, 2.5 Gbps downstream and 1.25 Gbps upstream.
3. Enables better bandwidth management based on DBA.
4. Enables long distances to be reached
5. Scalable
6. Ideal scenario for Hospitality environments such as Hoteles, Residences, Hospitals etc.



# CONNECTIVITY GPON TECHNOLOGY

- IKUSI's GPON OLTs are specially adapted to their application in hospitality: hotels, hospitals, singular buildings, ... . They are fully compatible with the ITU-T G.984X standard, resulting in an open platform, ready for all types of IP services: Data, VoIP, IPTV,..., or digital TV multiplexing with IKUSI's RF overlay equipment.
- Mechanically it is 1U high, and can be mounted in a 19" rack.
- Redundant power supply.
- Downlink: 8 GPON ports to be used with SFP C+ (SFP-125 ADAT. SFP GPON OLT C+: cod. 8325) or SFP B+ adapter. They are capable of supporting up to  $8 \times 128 = 1024$  (OLT-008) ONUs, with a maximum optical split ratio of 1:128. Each GPON port, has a bitrate of 2.488 Gbps upstream and 1.244 Gbps downstream.
- Uplink: 4GE + 4GE (SFP) + 2 X 10GE (SFP+).

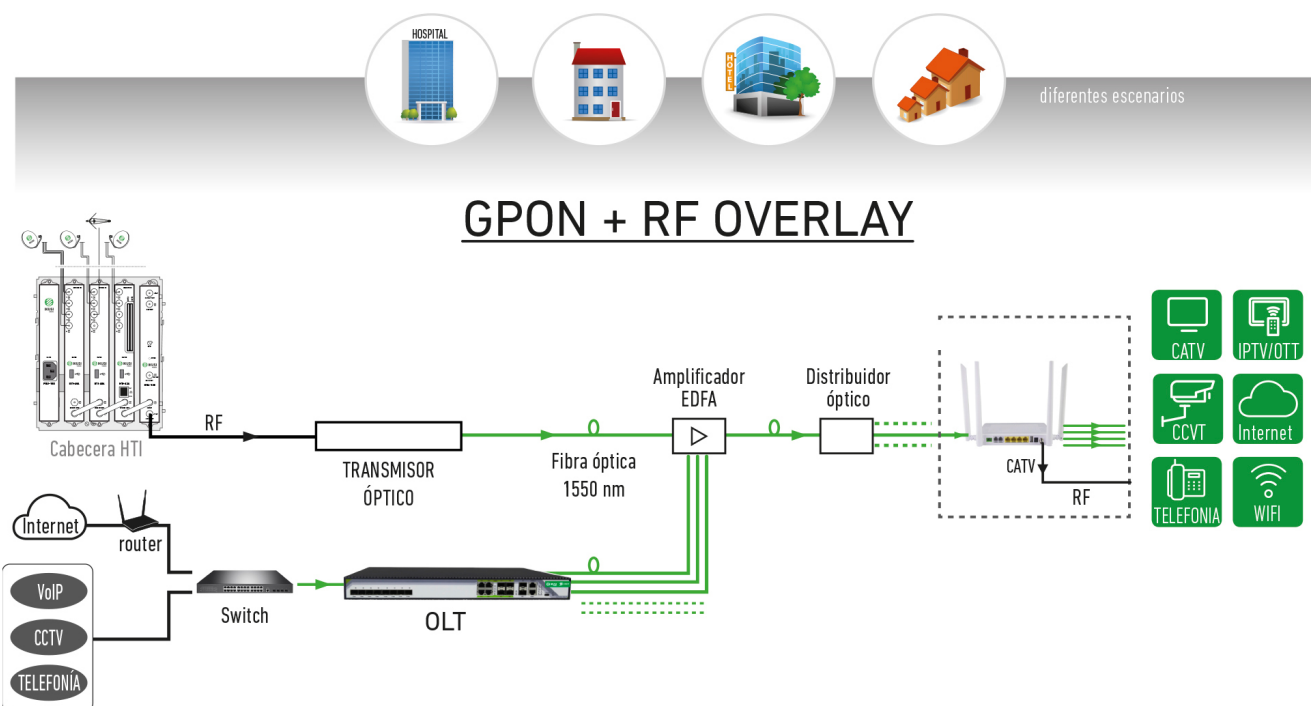
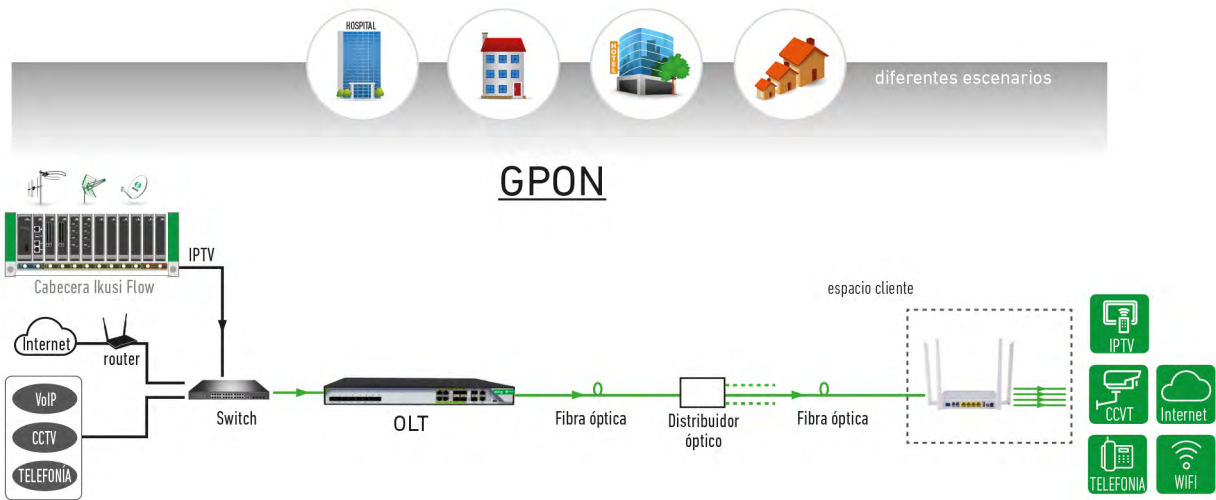

TYPICAL SCHEME

# GPON + RF Overlay

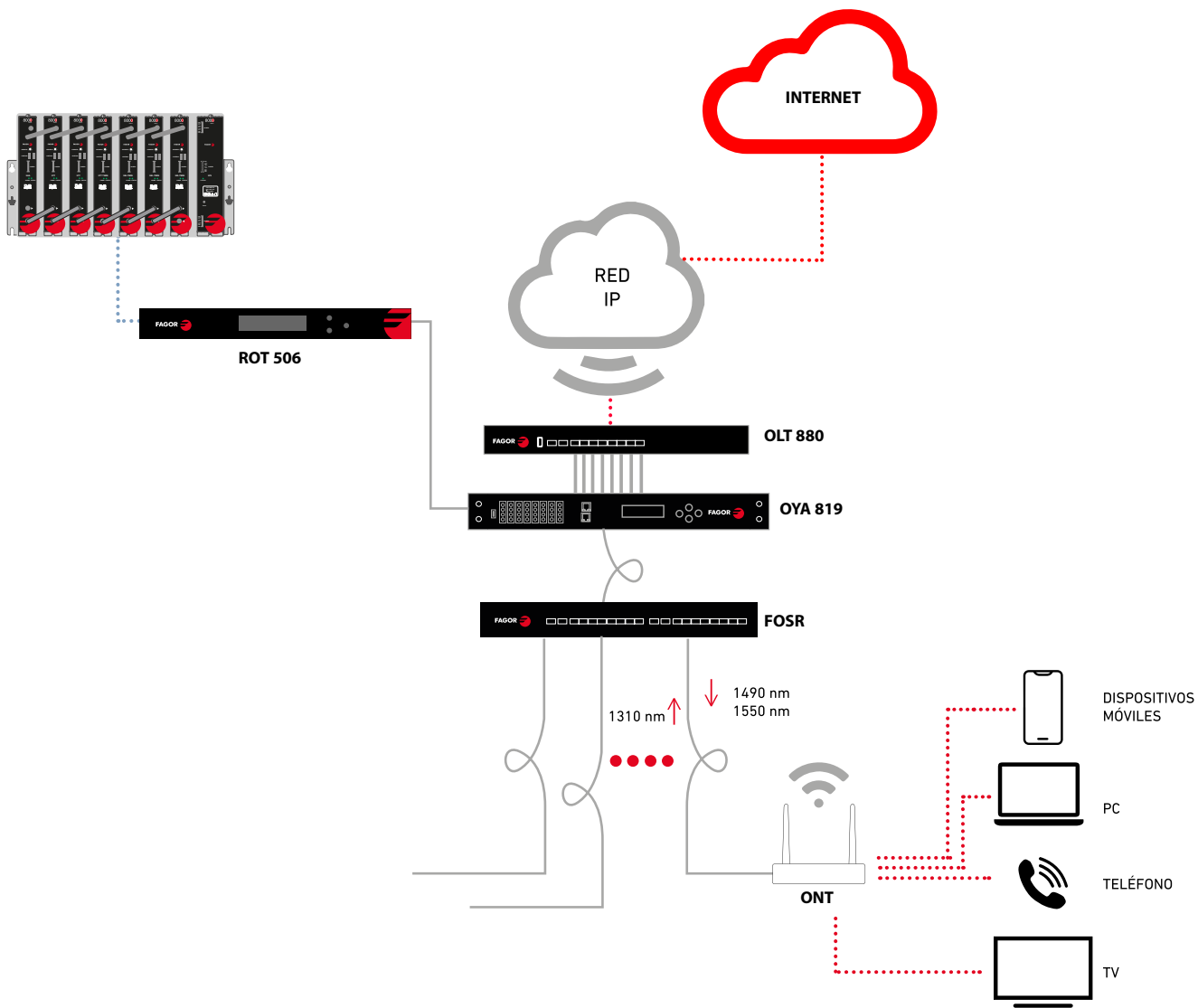

**OLT/GPON**

**OLT 008**

The OLT (Optical Line Terminal) is a device that integrates layer 2/3 functions, and controls both directions of communication (downlink and uplink), with 20 km being the maximum distance allowed for the transmission of information.

It can transmit multiple IP services: IPTV, Internet, telephony, CCTV... among others. It also facilitates the management of the optical network.

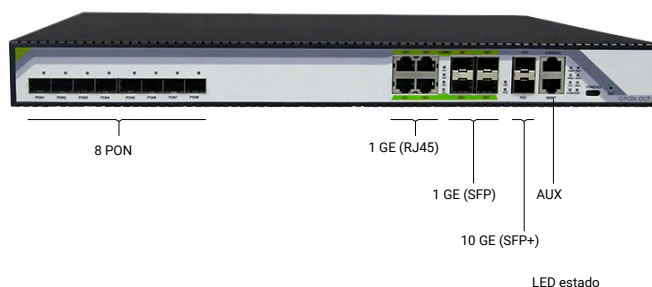

**GENERAL FEATURES**

- 1U - 19 inch
- Redundant Power Supply - Power Consumption < 70 watt
- Power supply
- DC -36V ~ -72V
- AC 90V ~ 240V 47/63Hz
- Dimensions 440 x 391 x 44 mm (L x W x H)
- Weight 4 kg
- Operating temperature 0°C to 50°C
- Ambient humidity 5% to 90% (non-condensing)

**GPON FEATURES**

- ITU-T G.984.x and ITU-T G.988 compliant - 20 km transmission distance
- Transmission distance of 20 km - Up to 128 ONTs per PON port
- Up to 128 ONTs per PON port - SC/UPC connectors - Supports Class B+ - Sensitivity -28 dBm
- SC/UPC connectors
- Supports Class B+ - Sensitivity -28 dBm - Saturation -8 dBm
- Supports Class c+ - Sensitivity -30 dBm - Saturation -12 dBm

**Ethernet Features**

- Auto-negotiation
- Full/half duplex mode
- 4 x 10/100/1000 Mbps RJ45 ports

**FEATURES**

**Network Management**

- CLI, Web, Telnet, SSH, SNMP, and EMS

**GPON**

- Supports dynamic bandwidth allocation
- AES encryption
- Flow control
- Auto discovery

MODEL	OLT-008
Reference	8302
Downlink PON	8
Uplink Ethernet 10/100/1000 Mbps	4
SFP	4
SFP+	2
Management	1
Console 1	1
USB	1

- Supports multiple authentication systems
- ONT management

**Layer 2:**

- Supports 4094 VLANs
- VLAN tag/untag
- Trunk/access/hybrid port
- Supports "VLAN translating" and "VLAN stacking: QinQ".
- Port isolation
- Port mirroring
- Spanning-tree
- RSTP
- Access Control List
- QoS
- Port, VID, TOS and MAC address level management

**Layer 3:**

- Flow control
- Multicast
- IGMP snooping/proxy
- Multicast group support
- DHCP-relay and DHCP-snooping
- DHCP-relay and DHCP-snooping
- Supports "vlanif"
- Support link-aggregation

## OPTICAL LINE TERMINATION FOR GPON NETWORKS

# OLT series

Headend equipment for GPON networks. Intuitive Web-based configuration without the need for external systems. 8 GPON downlink ports.

### FEATURES

- 6 GE SFP ports. 2 10GE SFP+ ports. 8 GE RJ45 uplink ports.
- ITU-T G.984.x and G.988 compliant.
- Remote management via SNMP/WEB/EMS.
- Speed per PON port: downstream 2.5Gbps. upstream 1.25 Gbps.
- Supports ONT auto-discovery and remote software upgrade via OMCI.
- Dual hot-swappable power supply.
- 1U 19" rack.

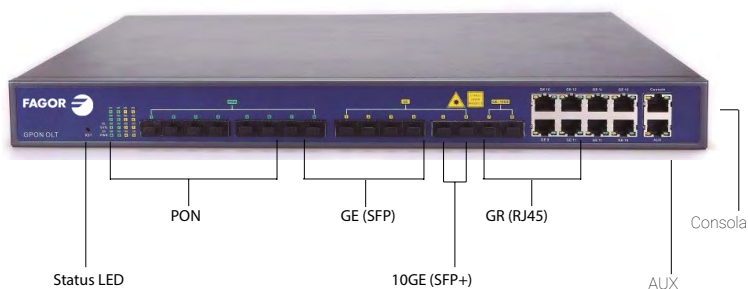

MODEL	OLT 880	
Reference	10421	
<b>INPUT</b>		
Uplink Interfaces	2 puertos 10GE (SFP+) 6 puertos 1GE SFP 8 puertos 1GE RJ45	
Management Interfaces	1 RJ45 FE AUX 1RJ45 consola	
CATV input power	dBm	-5 a 10
<b>OUTPUT</b>		
No. of GPON ports	8 puertos SFP	
No. of splitting per port	1:128	
Downstream bitrate per PON	Gbps	2,488
Upstream bitrate per PON	Gbps	1,244
GPON standard	ITU-T G.984.X/G-988	
Transmission distance	km	20
Wavelengths	nm	TX 1490 / RX 1310
SFP connectors	SC/UPC	
Fiber type	9/125um SM	
No. of VLANs	4096	
VLAN management	port VLAN, tag/untag, transparent transmission, VLAN translation, QinQ	
Multicast	256 grupos IP, IGMP snooping	
DHCP	server, relay, snooping	
QoS	por puerto, VID, TOS y MAC	
Management interface	Web/Telnet/CLI/EMS	
Management port	Ethernet RJ45	
Status LED	IN/OUT/POWER	
Mounting	19" rack 1U	
Power supply (redundant)	Vac	100 ÷ 240, 50-60Hz
Consumption	W	45
Operating temperature	°C	0 ÷ 50
Storage temperature	°C	-40 ÷ 85
Storage humidity	%	5 ÷ 90
Dimensions	mm	422 × 200 × 44

**ONT**

**ONT 524**

High performance to guarantee an excellent experience with video services, VoIP, Internet... It integrates wireless functions to provide users with greater efficiency and security in data transmission, in addition to having a wide range of coverage and penetration.

**GENERAL CHARACTERISTICS**

- Power consumption < 13w
- Power supply DC 12V/1'5A - Power supply DC 12V/1'5A
- Dimensions 240 x 240 x 24 mm (L x W x H x D)
- Weight 317 g
- Operating temperature 0-40°C
- Ambient humidity 10% to 90% (non-condensing)

**GPON features**

- Compliant with ITU-T standard G.984.1/2/3/4
- Gemport encapsulation
- SC/APC connector
- Class B+
- Sensitivity -28 dBm
- Saturation -8 dBm
- FEC
- Supports AES encryption
- Supports dynamic bandwidth allocation
- Supports auto-discovery Layer 2 and 3 functions
- VLAN tag/untag support
- DHCP client and server
- PPPoE client
- Static IP support
- Port binding support
- Multicast snooping/proxy support

**Telephony features**

- SIP/H248
- Codec compatible G711U/G711A/G729/G722
- Supported Fax Codec T38/G.711
- 2 RJ11 ports
- Jitter buffer
- Echo cancellation
- Call waiting and caller ID
- Ring balance

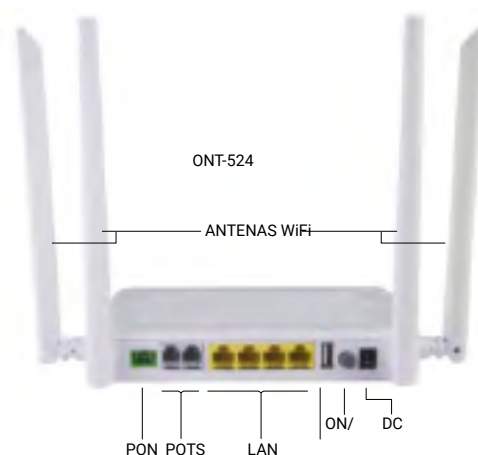

MODEL	ONT-524
Reference	8302
Ethernet ports	4
POT ports	2
CATV ports	x
WiFi	sí
USB	sí

**WiFi Features**

- IEEE802.11b/g/n/ac Standard
- Frequency range: 2'4 GHz and 5 GHz
- 2x2 MIMO
- 4 external 5 dBi antennas
- Multiple SSIDs
- WEP/WAP/WAP2 protection
- IEEE802.1x standard USB features
- 2.0 interface Network management
- Web
- Telnet
- TR069
- OMCI
- Missing ONT Alarm (Dying Gasp)
- Loop Detection Alarm
- Incident Alarm (Rogue)



**OPTICAL NETWORK UNIT FOR GPON NETWORKS**

**ONT 825 PoE**

GPON optical network terminal

**FEATURES**

- 8 10/100/1000BASE-T Ethernet ports with 48 V PoE.
- 1- and 2-band Wi-Fi with transfer rates from 300 to 1200 Mbps
- ITU-T G.984.x standard compliant
- Compatible with Triple play services: Internet, VoIP and IPTV
- Maximum speed: downstream 2.5Gbps, upstream 1.25 Gbps
- Management via OMCI, Web, SSH, TR069.



MODEL	ONT 825 PoE	
Reference	10435	
GPON standard	ITU-T G.984.X (G.984.5 WBF)	
Class	B+	
Wavelengths	nm	Downlink 1490 / Uplink 1310
SFP connectors	SC/UPC	
Authentication	SN or password according to G.984.3	
Other	Flexible mapping between GEM port and TCONT	
Ethernet ports	8GE RJ45 RJ45 POE (Max 30W/port) IEEE802.3at/af	
Router functionality	Bridging & Switching (802.1d / 802.1q). 8 traffic priorities (802.1p). VLAN filtering. IGMP multicast for IPTV	

**WIFI SPECIFICATION**

Standard	IEEE 802.11 b/g/n/ac	
(2.4/5G) 2X2 MIMO	300Mbps (2.4G), 867Mbps (5G)	
Bandwidth	300Mbps (2.4G), 867Mbps (5G)	
Antenna	4x2dBi	
Other	4+4 SSID	
Management interface	Web/OMCI/TR069	
Status LEDs	POWER/PON/LOS/WLAN	
Assembly	Wall-mounted and table-top (weatherproof enclosure optional)	
Power supply (redundant)	V	48Vdc, 2.5A
Consumption	W	<120W
Operating temperature	°C	-30 ÷ 55
Storage temperature	°C	-30 ÷ 60
Storage humidity	%	10 ÷ 90
Dimensions	mm	196 x 160 x 32
Weight	Kg	0,32

**OPTICAL NETWORK UNIT FOR GPON NETWORKS**

**ONT 115, 412 C & 425**

GPON optical network terminal.

**FEATURES**

- Several 10/100/1000BASE-T Ethernet ports.
- 1- and 2-band Wi-Fi with transfer rates from 300 to 1200 Mbps.
- POTS port for telephony.
- Compatible with ITU-T G.984.x standard.
- Compatible with Triple play services: Internet, VoIP and IPTV.
- Maximum speed: downstream 2.5Gbps. upstream 1.25 Gbps.
- Management via OMCI. Web. SSH. TR069.



MODEL	ONT 115	ONT 412 C	ONT 425
Reference	10433	10431	10434
<b>GPON Standard</b>	ITU-T G.984.X (G.984.5 WBF)		
Class	B+		
Wavelengths	Downlink 1490 / Uplink 1310		
SFP Connectors	SC/UPC	SC/APC	SC/UPC
Authentication	SN o contraseña según G.984.3		
Other	Mapeo flexible entre GEM port y TCONT		
Ethernet ports	4GE RJ45		
Router functionality	Bridging & Switching ( 802.1d / 802.1q) 8 prioridades de tráfico (802.1p). Filtrado de VLANs. IGMP multicast para IPTV		

<b>CATV</b>			
Bandwidth	---	47-1000MHz	---
Impedance	---	75	---

<b>TELEPHONY POTS</b>			
82dBµV con CAG (+2~ -10dBm)			
<b>REN</b>			
Connectors	2 RJ11	1 RJ11	
Ring tones	DTMF		
Protocols	G.711A/µ, G.729a/b, and G.722, T.30/T.38/G.711 fax mode, SIP		

<b>WIFI SPECIFICATION</b>			
Standard	IEEE 802.11 /b/g/n (2.4) 2x2 MIMO	IEEE 802.11 b/g/n/ac (2.4/5G) 2x2 MIMO	IEEE 802.11 a/b/g/n/ac/ax (2.4/5G/WIFI6) MU-MIMO
Bandwidth	300Mbps	300Mbps (2.4G), 867Mbps (5G)	300Mbps (2.4G), 867Mbps (5G), 574+1201Mbps (WIFI6)
Antenna	2x5dBi	4x5dBi	4x5dBi
Others	4 SSID	4-4 SSID	4+4 SSID
Management interface	Web/OMCI/TR069		
Status LED	POWER/PON/LOS/LAN/TEL/USB/WLAN/WPS		
Mounting	Pared y sobremesa		
Power supply (redundant)	V	12Vdc, 1.5A (adaptador AC incluido)	
Consumption	W	<10	<12
Operating temperature	°C	0 ÷ 50	
Storage temperature	°C	-30 ÷ 70	
Storage humidity	%	5 ÷ 95	
Dimensions	mm	205 x 140 x 37	173 x 120 x 30
Weight	Kg	0,34	0,42



**OPTICAL TRANSMITTER**

**ROT series**

1550 nm optical transmitter for use in FTTH. FTTx PON. Triple-play and RF Overlay.

**APPLICATION**

- Conversion of RF signals into amplitude-modulated optical signals for CATV HFC networks.

**FEATURES**

- Equipped with DFB laser. for very good linearity and high optical output power.
- Advanced multi-frequency RF predistortion technology ensures perfect CTB and CSO performance at high standard CNR value.
- Automatic gain control (AGC) enables stable output at different RF input levels.
- Different networks can be optimized by OMI adjustment.
- Automatic temperature control, which ensures a long service life of the device.



- Built-in dual backup power supply.
- Configuration of system parameters controlled by the front panel keypad or by the user-friendly web interface.
- A standard RJ45 interface is provided. which supports SNMP and WEB remote network management.

MODEL		ROT 506
Reference		10400
<b>OPTICAL PARAMETERS</b>		
Output power	dBm	6
Output wavelength	nm	1550
Laser linewidth		0,65
SMSR	dB	≥45
XP	dB	≥20
RIN	dB/Hz	≤-160
Optical return loss	dB	≥50
Fiber connector		SC/APC
<b>RF PARAMETER</b>		
Frequency Range	MHz	47-862
Input level	dBμV	70...100
Flatness	dB	±0,75
CNR	dB	≥51
CTB	dB	≥65
CSO	dB	≥60
Return loss	dB	≥16
Input impedance	Ω	75
RF connector		F-hembra
<b>OTHER PARAMETERS</b>		
Network management interface		SNMP y WEB
Power supply	V	90 ÷ 265
Power consumption	W	≤30
Operating temperature	°C	-5 ÷ 55
Storage temperature	°C	-40 ÷ 85
Operating relative humidity	%	5 ÷ 95
Dimension	mm	370 × 483 × 44

## OPTICAL YEDFA AMPLIFIER

**OYA series**

Optical amplifier in rack format, compatible with EPON/GPON systems.

**APPLICATION**

- Suitable for fiber optic signal distribution.

**FEATURES**

- 8 WDM (RF Overlay+GPON) output ports.
- Output power 8\*19dBm.
- Adjustable output power from -3 to 0 dB.
- Wide input range from -5 to 10 dBm.
- Very low noise figure.
- Input/output/status/power status indicator LEDs.
- Laser Bias input level and current monitoring and alarms.
- Dual hot-swappable power supply.
- Control and monitoring via WEB/SNMP.
- 1U 19" rack.



MODEL		OYA 819
Part number		10412
No. of ports OLT		8
<b>INPUT</b>		
CATV Wavelength	nm	1540-1560
OLT Wavelength	nm	1310/1490
CATV input power	dBm	-5 a 10
<b>OUTPUT</b>		
Output power	dBm	8*19
Output power regulation	dB	-3 a 0
Power stability per port	dB	0,1
Noise figure (@6dBm Input)	dB	4 (max. 5,8)
<b>INPUT-OUTPUT</b>		
Return loss	dB	55
IN-OUT isolation	dB	30
OLT optical connectors		SC/UPC
CATV+OUT optical connectors		SC/APC
<b>OTHER PARAMETERS</b>		
Management interface		SNMP/WEB
Management port		Ethernet RJ45
Display and buttons		LCD/4
Status LED		IN/OUT/POWER
<b>Mounting</b>		
Power supply (redundant)	V	90 ÷ 265
Consumption	W	≤50
Operating temperature	°C	-5 ÷ 50
Storage temperature	°C	-20 ÷ 85
Storage humidity	%	5 ÷ 95
Dimension	mm	483 × 422 × 44
Weight	Kg	11,5



## SWITCH ETHERNET 26 PORTS

# ECS 226

Intelligent switch with 24 Fast Ethernet ports plus 2 Gigabit Ethernet (GbE) uplinks.

### APPLICATION

Suitable for IPTV signal distribution.



### FEATURES

- Web-based user interface
- Download and copy configuration between switches
- Multicast IGMP Querier, snooping
- Reset button

MODEL		ECS 226
Reference		10501
Interfaces		"24xGbE+ 2xGbE/SFP Combo Uplink"
Capacity Switching	Gpbs	52
Baud rate	Mpps	38,69
MAC Addresses		8192
Concurrent VLANs		256
Power Supply	V~,Hz	100-240, 50-60
	W	18
Operating temperature	°C	0-50
Dimensions	mm	440x201x44
Weight	Kg	2.81

## Switch 24 GE + 4 x 10G SFP+ L2/L3 POE

# SWI024G

The SWI024G is an L2/L3 manageable switch equipped with 24 Gigabit RJ45 ports and 4 10G SFP+ slots.

All RJ45 ports support the 802.3 af/at (PoE+) standard and provide a total PoE power of 380W.

Multiple L3 compatible management functions are available.

The SWI024G is capable of delivering high performance even in the most demanding installations, while in smaller networks it can act as a backbone for Gigabit switches and high-speed servers. 4 SFP+ slots provide greater network flexibility.

The SWI024G is designed exclusively for the networking needs of growing installations, with a comprehensive set of management and security features.

### APPLICATION

This product is suitable for small and medium-sized installations and offers ideal solutions for a wide variety of network scenarios.

### CHARACTERISTICS

- 4 SFP+ 10 Gbps slots
- 24 RJ45 10/100/1000Mbps ports. POE 802.3 af/at-
- Management and administration via WEB, CLI, TELNET, SNMP
- Supports IEEE 802.1Q VLAN, QoS, ACL, SSL
- Supports Spanning Tree, Multicast IPV6, SNMP
- Supports 802.1X certification-
- Supports ERPS ring network
- Supports RSTP/MSTP spanning tree
- Supports RSTP/MSTP.
- Support Port Security, Port Monitoring and Port Isolation
- Support AI smart POE, auto detect PD devices, support PoE Watchdog
- Support Quaternary binding, ARP/IP/DoS protection -



### Mechanical Rack 19" 1U

- Support IEEE 802.3i, 802.3u, 802.3ab, 802.3z, 802.3x, 802.3az, 802.3at, 802.3af.- 24 802.3 af/at compliant POE ports, per port up to 30W, and 380W total PoE power.
- Features self-learning and self-aging of MAC addresses.
- Operates in store and forward mode
- LED indicators for power, link/activity monitoring
- Supports QoS, port mirroring and link aggregation protocol
- Designed in a 19-inch metal enclosure, with internal power supply. Suitable for rackmount installation.



# CONNECTIVITY GPON SERVICES



WIFI, VoIP, Hotspot,  
CYBERSECURITY, CCTV

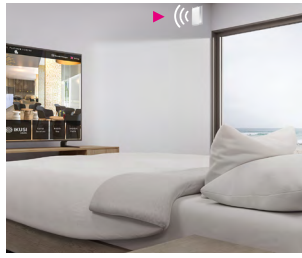

Room WIFI, IPTV, VoIP,



Common indoor areas  
WIFI, CCTV,...



Common outdoor areas  
WIFI, CCTV,...

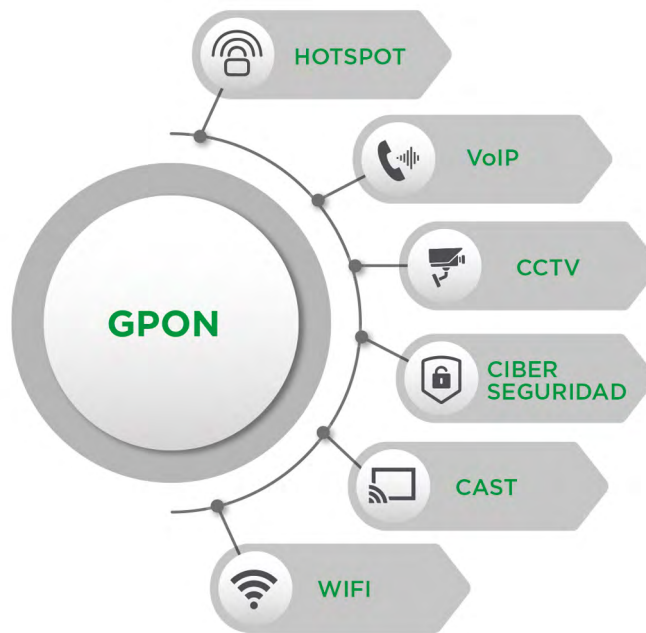

## WIFI/GPON

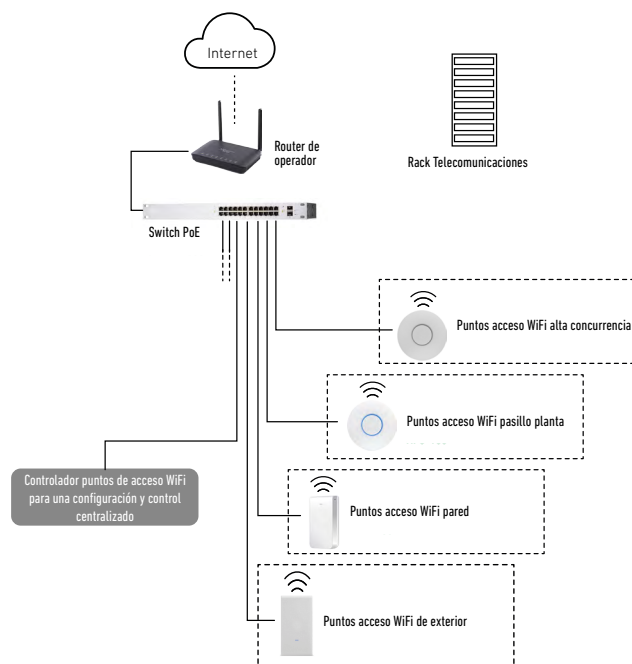



Fagor Electrónica, S.Coop.  
San Andrés, s/n.  
E-20500 Mondragón (Spain)  
Tel.: 943 712526  
Fax: 943 712893  
E-mail: [rf.sales@fagorelectronica.es](mailto:rf.sales@fagorelectronica.es)  
**[www.fagorelectronica.com](http://www.fagorelectronica.com)**

Donostia Ibilbidea 28 .  
20115 Astigarraga - Gipuzkoa  
España  
Tel.: +34 943 44 89 44  
**[www.ikusi.tv](http://www.ikusi.tv)**

